

Accessories

Support Unit (Support Units for Light Load and Small Equipment)

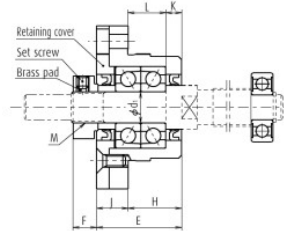

View X-X (example 1)

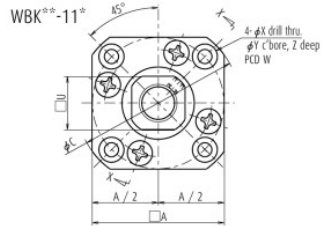
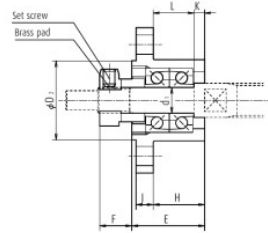
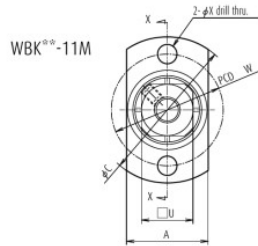
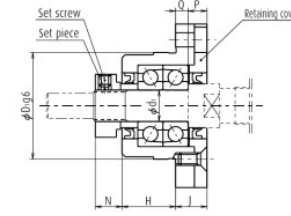
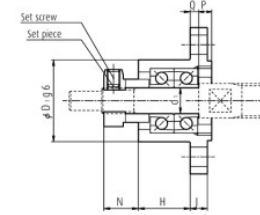

(example 2)

Reference No.	Tightening torque (reference) [N·cm]	
	Locknut	Set screw
WBK04- ⁰⁰	100	69 (M3)
WBK06- ⁰⁰	190	69 (M3)
WBK08- ⁰⁰	230	69 (M3)
WBK10- ⁰⁰	280	147 (M4)
WBK12- ⁰⁰	630	147 (M4)
WBK15- ⁰⁰	790	147 (M4)
WBK17- ⁰⁰	910	147 (M4)
WBK20- ⁰⁰	1670	147 (M4)
WBK25- ⁰⁰	2060	490 (M6)

Fixed support side support unit (round type)

Reference No.	Use	d ₁	A	C	D ₁	D ₂	E	H	L	K	F	N
WBK04-11M	General	4	14	26	14	14	13.5	8.5	7	1.5	5.5	6.6
WBK06-11M	General	6	19	34	19	18.5	17	12	9.5	2.5	7.5	8
WBK06-11 ⁰	General	6	28	35	22	—	20	13	9.5	3.5	5.5	6.5
WBK08-11B	High-load type	8	42	52	34	—	25.5	15.5	12	3.5	4.5	7
WBK08-11 ⁰	General	8	35	43	28	—	23	14	10	4	7	8
WBK08-11C ⁰	Clean environment	8	35	43	28	—	23	14	10	4	7	8
WBK10-11	General	10	42	52	34	—	27	17	12	5	7.5	8.5
WBK10-11C	Clean environment	10	42	52	34	—	27	17	12	5	7.5	8.5
WBK12-11	General	12	44	54	36	—	27	17	12	5	7.5	8.5
WBK12-11C	Clean environment	12	44	54	36	—	27	17	12	5	7.5	8.5
WBK15-11	General	15	52	63	40	—	32	17	11	6	12	14
WBK15-11C	Clean environment	15	52	63	40	—	32	17	11	6	12	14
WBK20-11	General	20	68	85	57	—	52	30	20	10	10	14
WBK25-11	General	25	79	98	63	—	57	30	20	10	13	20

- Notes**
1. Tighten set screw after locknut has been adjusted and tightened.
 2. Insert brass pad provided with unit into locknut set screw hole, then insert and tighten the set screw.
 3. Deep groove ball bearing and snap ring are also provided for simple support side. (except WBK04-11M and WBK06-11M)

Unit: mm

U	P	Q	Counterbore dimensions					Mass (kg)	Locknut screw M	Attached bearing for support side
			J	W	X	Y	Z			
0	2.6	2.4	3	20	3.5	—	—	0.02	M4×0.5	—
12	3	2	4	26	4.5	—	—	0.04	M6×0.75	—
12	4.5	2.5	7	28	2.9	5.5	3.5	0.1	M6×0.75	—
14	6	4	10	42	4.5	8	4	0.2	M8×1	606ZZ
14	5	4	9	35	3.4	6.5	4	0.15	M8×1	606ZZ
14	5	4	9	35	3.4	6.5	4	0.15	M8×1	606VV
17	6	4	10	42	4.5	8	4	0.2	M10×1	608ZZ
17	6	4	10	42	4.5	8	4	0.2	M10×1	608VV
19	6	4	10	44	4.5	8	4	0.25	M12×1	6000ZZ
19	6	4	10	44	4.5	8	4	0.25	M12×1	6000VV
22	8	7	15	50	5.5	9.5	6	0.4	M15×1	6002ZZ
22	8	7	15	50	5.5	9.5	6	0.4	M15×1	6002VV
30	14	8	22	70	6.6	11	10	1.1	M20×1	6204ZZ
36	17	10	27	80	9	15	13	1.5	M25×1.5	6205ZZ

4. Bearings for WBK04-01M and WBK06-01M are equipped with non-contact metal shield.
- *For retaining cover side of WBK06-01A, WBK08-01A, and WBK08-01C, there are no seals.
5. Contact NSK if the rotational speed is 50 min⁻¹ and below.