

A-5-1.1 NH Series

10. Dimensions

NH-AN (High-load type / Standard)
NH-BN (Super-high-load type / Long)

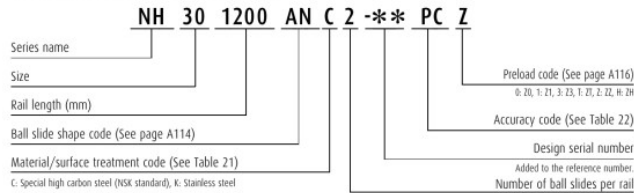

Front view of AN and BN types

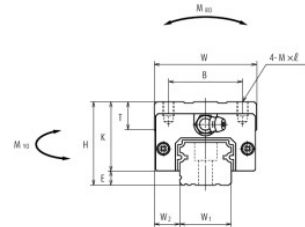

Side view of AN type

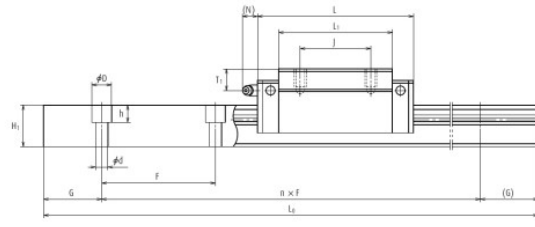

Side view of BN type

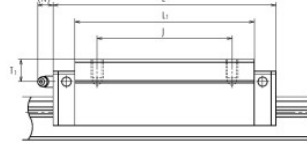

Model No.	Assembly			Ball slide										Width	Height		
	Height	Width		Length	Mounting hole			L ₁	K	T	Grease fitting					W ₁	H ₁
		H	E		W ₂	B	J				M × pitch × ℓ	Hole size	T ₁				
NH15AN	28	4.6	9.5	34	55	26	26	M4×0.7×6	39	23.4	8	φ 3	8.5	3.3	15	15	
NH15BN	28	4.6	9.5	34	74	26	26	M4×0.7×6	58	23.4	8	φ 3	8.5	3.3	15	15	
NH20AN	30	5	12	44	69.8	32	36	M5×0.8×6	50	25	12	M6×0.75	5	11	20	18	
NH20BN	30	5	12	44	91.8	32	50	M5×0.8×6	72	25	12	M6×0.75	5	11	20	18	
NH25AN	40	7	12.5	48	79	35	35	M6×1×9	58	33	12	M6×0.75	10	11	23	22	
NH25BN	40	7	12.5	48	107	35	50	M6×1×9	86	33	12	M6×0.75	10	11	23	22	
NH30AN	45	9	16	60	85.6	40	40	M8×1.25×10	59	36	14	M6×0.75	10	11	28	26	
NH30BN	45	9	16	60	124.6	40	60	M8×1.25×10	98	36	14	M6×0.75	10	11	28	26	
NH35AN	55	9.5	18	70	109	50	50	M8×1.25×12	80	45.5	15	M6×0.75	15	11	34	29	
NH35BN	55	9.5	18	70	143	50	72	M8×1.25×12	114	45.5	15	M6×0.75	15	11	34	29	
NH45AN	70	14	20.5	86	139	60	60	M10×1.5×17	105	56	17	Rc1/8	20	13	45	38	
NH45BN	70	14	20.5	86	171	60	80	M10×1.5×17	137	56	17	Rc1/8	20	13	45	38	
NH55AN	80	15	23.5	100	163	75	75	M12×1.75×18	126	65	18	Rc1/8	21	13	53	44	
NH55BN	80	15	23.5	100	201	75	95	M12×1.75×18	164	65	18	Rc1/8	21	13	53	44	
NH65AN	90	16	31.5	126	193	76	70	M16×2×20	147	74	23	Rc1/8	19	13	63	53	
NH65BN	90	16	31.5	126	253	76	120	M16×2×20	207	74	23	Rc1/8	19	13	63	53	

Notes 1) External appearance of stainless steel ball slides differs from those of carbon steel ball slides.

Reference number for ball slide of random-matching type

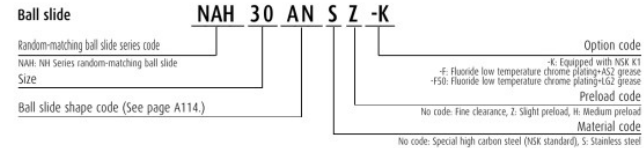

AN and BN types

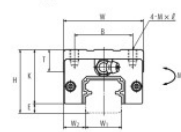

AN type

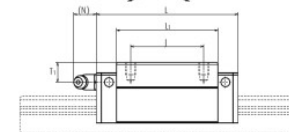

BN type

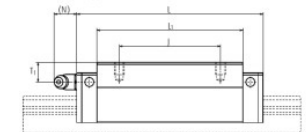

Reference number for rail of random-matching type

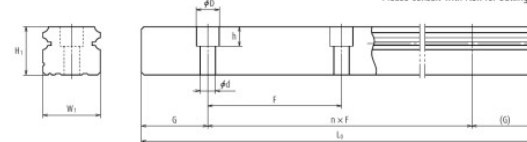
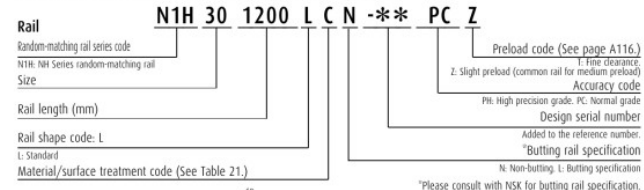

Unit: mm

Pitch	Rail			Basic load rating							Weight		
	Mounting bolt hole d × D × h	G (reference)	Maximum length L _{max} () for stainless	2) Dynamic		C ₀ (N)	M ₈₀	Static moment (N-m)				Ball slide (kg)	Rail (kg/m)
				[50km] C ₅₀ (N)	[100km] C ₁₀₀ (N)			M _{P0}		M _{Y0}			
								One slide	Two slides	One slide	Two slides		
60	4.5×7.5×5.3	20	2 980	14 200	11 300	20 700	108	94.5	575	79.5	480	0.18	1.6
60	4.5×7.5×5.3	20	(1 800)	18 100	14 400	32 000	166	216	1 150	181	965	0.26	1.6
60	6×9.5×8.5	20	3 960	23 700	18 800	32 500	219	185	1 140	155	955	0.33	2.6
60	6×9.5×8.5	20	(3 500)	30 000	24 000	50 500	340	420	2 230	355	1 870	0.48	2.6
60	7×11×9	20	3 960	33 500	26 800	46 000	360	320	1 840	267	1 540	0.55	3.6
60	7×11×9	20	(3 500)	45 500	36 500	71 000	555	725	3 700	610	3 100	0.82	3.6
80	9×14×12	20	4 000	41 000	32 500	51 500	490	350	2 290	292	1 920	0.77	5.2
80	9×14×12	20	(3 500)	61 000	48 500	91 500	870	1 030	5 600	865	4 700	1.3	5.2
80	9×14×12	20	4 000	62 500	49 500	80 500	950	755	4 500	630	3 800	1.5	7.2
80	9×14×12	20	4 000	81 000	64 500	117 000	1 380	1 530	8 350	1 280	7 000	2.1	7.2
105	14×20×17	22.5	3 990	107 000	84 500	140 000	2 140	1 740	9 750	1 460	8 150	3.0	12.3
105	14×20×17	22.5	3 990	131 000	104 000	187 000	2 860	3 000	15 600	2 520	13 100	3.9	12.3
120	16×23×20	30	3 960	158 000	125 000	198 000	3 600	3 000	16 300	2 510	13 700	4.7	16.9
120	16×23×20	30	3 960	193 000	153 000	264 000	4 850	5 150	26 300	4 350	22 100	6.1	16.9
150	18×26×22	35	3 900	239 000	190 000	281 000	6 150	4 950	27 900	4 150	23 400	7.7	24.3
150	18×26×22	35	3 900	310 000	246 000	410 000	8 950	10 100	51 500	8 450	43 500	10.8	24.3

2) The basic load rating comply with the ISO standard. (ISO 14728-1, 14728-2)
C₅₀: the basic dynamic load rating for 50 km rated fatigue life C₁₀₀: the basic dynamic load rating for 100 km rated fatigue life
The basic static load rating shows static permissible load.
3) High-precision grade and medium preload of random-matching type are available for high-carbon steel products.